

How to Change a Password on Windows Computer

1. Press the Ctrl+Alt+Delete keys.
2. Select the Change a password option.

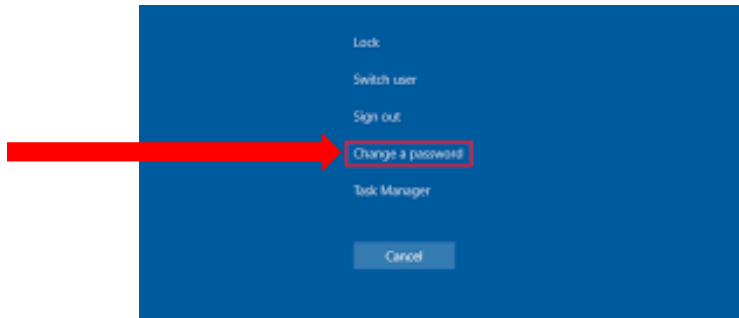

Leave the top box alone!

3. Type your Old password in the Old password box
4. Type the new password in the New password box
5. Type the SAME new password again in the Confirm password box (they must match or you will get an error message)
6. Press Enter or the arrow to change your password

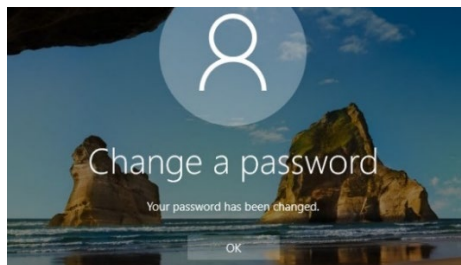

7. When you see message that your password has been changed, click OK.
8. Your password is now changed for your computer & Office 365 account.